

## Latching Type Water Valve Specification

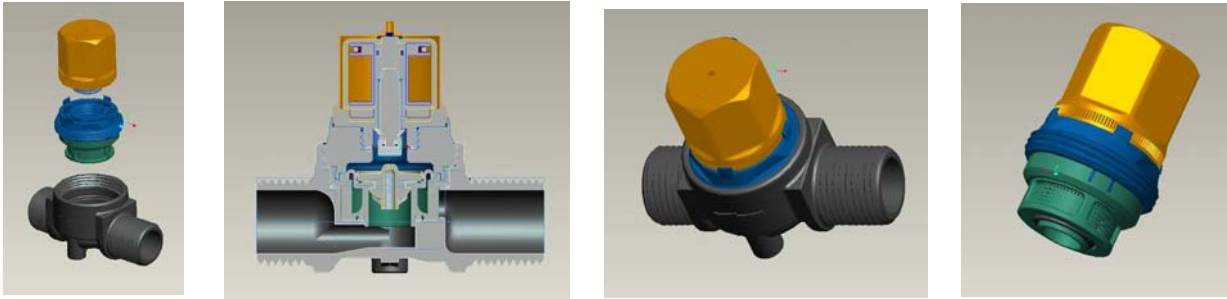

NO	SPEC ITEM	Content	Remark
1	Normal Voltage	6VDC	
2	Battery type	AA - 1.5 V alkaline * 4	
3	Operating Power Consumption	7.2 W	
4	Ambient Temp. Range	1 - 40 °C	
5	Working Water Temp	3.9~85.2 °C	
6	Ambient Humidity Range	95 % RH max	
7	Valve Design Structure	Latching Type with Diaphragm	
8	Mechanic Life	Min 1,000,000 Cycles, Based on 10 sec on / 10 sec off at 3 Kgf / cm <sup>2</sup>	
9	Coil Resistance	5 ± 7% ohm. ( at 20°C)	
10	Valve Body Material	PPS	
11	Diaphragm Material	Silicon	
12	Spring Material	Stainless Steel	
13	Plunger Material	Stainless Steel	
14	Burst Pressure	500/psi	
15	Intake / Outlet Thread Size	1/2" N.P.S	
16	Flow Rate	min 6GPM at 3 Kgf/cm <sup>2</sup> Dynamic Pressure	
17	Working Pressure Range	0.3Kgf/cm <sup>2</sup> ~ 10Kgf/cm <sup>2</sup> Static Pressure	
18	Valve Driving Pulse -- Open	20ms During 4.8V~6.4VDC ,at 10 Kgf/cm <sup>2</sup>	Note 1
19	Valve Driving Pulse -- Close	5ms During 4.0V~6.4VDC ,at 10 Kgf/cm <sup>2</sup>	Note 1

Note 1 : Driving pulse will be changed since Tolling still in the modify phase !!!

2010/02/02